

CIRCUIT DIAGRAM

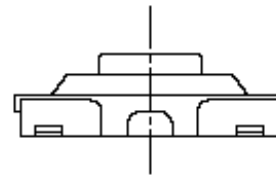

P.C.B LAND DIMENSION

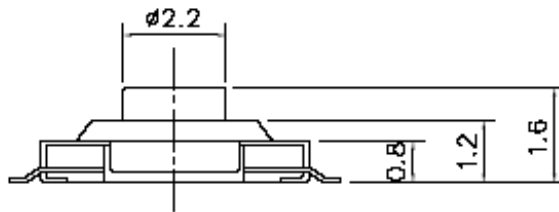
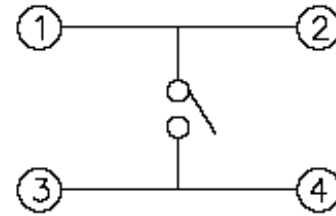
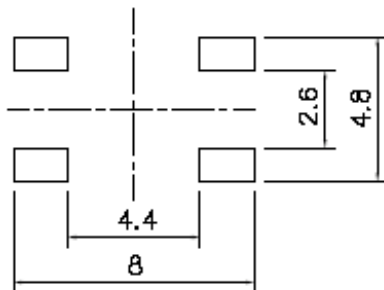

SPECIFICATIONS

1. RATING : DC 12V, 50mA Max
2. CIRCUIT : 1C - 1P
3. OPERATING FORCE : 160±30gf, 250±50gf
4. CONTACT RESISTANCE₀: 100mΩ Max
5. TRAVEL : 0.25±0.1mm
6. LIFE : 100,000Cycles Min
7. TOLERANCE : ±0.2

NO	DESCRIPTION	MATERIAL	SPECIFICATION			TREATMENT	REMARK		
4			APPROVAL	CHECK	DESIGN	TITLE	TACT SWITCH		
3								MODEL	KPT-1187B
2									
1						DRAW' No			
MARK	DATE	REVISION	SIGN						